

Introducing the **2018**

# BRUMBY



This is the camper Cub is known for – with good reason. It is built to cope with outback conditions; with a rugged construction and compact body it can go places others can't. Also comes with a 5-year warranty on the canvas, independent suspension and chassis.

The hard floor keeps you high and dry, in the desert or the rainforest and the 2018 model is packed with premium features. There's a new 2-burner Smev stove and stainless steel sink, LED bedside lighting, solar input, two 4kg gas bottles, two 20L jerry can holders, 80L water tank, loads of power inclusions and more!



## THE ICONIC CAMPER FOR OFF ROAD



4WD



UP TO 4



OFF ROAD

AUSTRALIAN CANVAS, AUSTRALIAN STEEL,  
AUSTRALIAN MADE, AUSTRALIAN OWNED

AUSTRALIA WIDE SUPPORT

5 YEAR CANVAS WARRANTY\*

5 YEAR SUSPENSION & CHASSIS WARRANTY\*



*Celebrating  
50 years  
Est. 1968*

[cubcampers.com.au](http://cubcampers.com.au) 1300 CAMPING (1300 226 746)

\* conditions apply

V.201803

# | BRUMBY SPECS |

BODY SPECS	
Body Length	2.20M
Body Width	1.70M
Towing Height	1.65M
Towing Length	4.35M
Open Length (including drawbar)	6.60M
Tare	885kg ‡
Ball Weight	139kg ‡
ATM	1400kg
Colour	Meteor Grey Metallic

BRAKES & WHEELS	
17" 6 Stud Alloy Wheels with Goodyear Duratrac Tyres	Standard
AL-KO 50mm Axle with 10" Electric Brakes	Standard
Hand Brake Protector	Standard
Rear Wind Up Spare Wheel (Steel)	Standard

CANVAS	
100% Australian Made Tent using Wax Converters Dynaproof Canvas	Grey
Aluminium Awning Poles	Standard
Extended Deluxe Awning	Standard
Sewn in Canvas Window Flaps & Midge Proof Fly Screen	Standard

DRAWBAR	
4Kg Gas Bottle & Holder	x2
20L Jerry Can Holder	x2
100 x 50 x 3.0mm Drawbar (4")	Standard
2.0mm Alloy Large Fridge Box & Slide	Standard
Galvanised Steel Stoneguard	Standard
Silent Winch	Standard
AL-KO 250mm Jockey Wheel with Single Clamp	Standard
AL-KO 50mm Offroad Ball Hitch	Standard
Safety Chain Keeper	Standard
Stone Stopper Mud Flaps	Standard

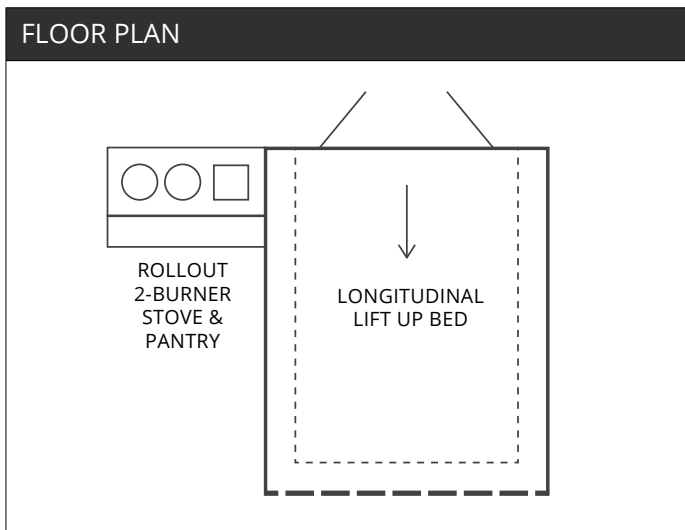

INSIDE FITTINGS	
Aluminium Composite Panel	Standard
Bed – 2130 x 1350 Medium Density Foam Mattress	Standard
Bed Storage Divider	Standard
Carpet in Bed Area	Standard

KITCHEN	
Smev 2 Burner Stainless Steel Stove & Sink	Standard
Stainless Steel Pantry	Standard

OUTSIDE FITTINGS	
Alloy Driver's Side Locker Door	Standard
Alloy Passenger Side Locker Door	Standard
Alloy Roof Rack with Built in Luggage Rack	Standard
Pole Carrier	Standard
Roof rack Stabiliser legs with 180mm Adjustment	Standard

POWER & LIGHTS	
240V External Inlet (15 Amp)	Standard
240V External Outlet	Standard
240V Internal Outlet	x2 Doubles
Projecta IC2510 Battery Charger & Monitor	Standard
Projecta IDC25 12V DC-DC Charger	Standard
Narva 12V Internal Outlet (1 x Merit, 1 x ACC)	x2
Narva 12V External Outlet (Merit)	x2
100 Amp Hour Battery	Standard
LED Strip Light	Standard
LED Bed Side Stalk Lights	x2
LED Kitchen Light	Standard
Twin USB Socket	x2
Solar Input (Anderson Plug) - Suits Unregulated Solar Panel	Standard

SUSPENSION & CHASSIS	
AL-KO Wind Down Legs	Standard
Australian Galvanised Steel Chassis	Standard
Independent Suspension	Standard
Rear Recovery Points (2400kg Rating)	x2

WATER	
12V Water Pump	Standard
80L Heavy Duty Water Tank	Standard
Handpump on Drawbar	Standard
Locking Water Filler	Standard
Water Gauge	Standard

*All model specification details are subject to change*

**‡ The tare and ball weights are a guide only** and will change depending on drawbar layout and accessories fitted to your camper. Please discuss with a member of the Cub sales team prior to purchase.



TRAVEL PACK

# BRUMBY

THE ICONIC CAMPER FOR THE OFF ROAD

Once you have chosen the right camper for your adventures you can then choose one of our travel packs and add popular options to suit your travelling needs.

We have put some of our most popular options into Cub Travel Packs so you can get the options you want at a great price. Other popular options can also be added individually and the prices for each have been listed below.

## ADVENTURE PACK\*

(Save \$469)

2nd 100 AMP Hour Battery (Fitted)	
2nd Water Tank (80L)	
Utility Rack Upgrade	
Utility Spare Wheel Bracket	

SAVE \$469  
PACK PRICE ONLY  
**\$1,300**  
RRP \$1,769

\*Adventure Pack adds approx. 143kg to total camper trailer weight when the extra water tank is full.

## POPULAR OPTIONS

Available on the Brumby

Boat Loader	\$1950
Canvas Front Wall with Window	\$770
Canvas ½ Long Wall with Door	\$562
Canvas ½ Long Wall with Window	\$562
Canvas Rear Wall	\$470
Draught Skirt	\$225
Pocket Spring Mattress Upgrade	\$435
Stainless Steel Side Shelf	\$285
Tropical Roof	\$899
Utility Bike Rack Hayman Reece Bracket	\$210



[cubcampers.com.au](http://cubcampers.com.au)  
1300 CAMPING  
(1300 226 746)

