



UNDERSTATED ELEGANCE



2024

AUSTRALIA'S BEST **HYBRIDS**



EQUAL OVERALL WINNER



**BEST BUILD QUALITY
BEST COUPLES HYBRID**



Don't let the simplicity and minimalist elegance of Cub Camper's H16 fool you — this is a dingo in sheep's clothing which will take you down the toughest offroad tracks that would be out of bounds for the big boys. The H16 was judged the Equal Overall Winner of Australia's Best Hybrids 2024.



SCAN TO PLAY VIDEO

Words ABH Judges
Pics Capture Factory



TIM VAN DUYL
CARAVAN WORLD CREATIVE DIRECTOR

BUILD QUALITY

This is the third Cub 16 I've sampled but the first H, the other two models being the award-winning C16 and L16. Where they differ is in the H having a pop-top and hybrid designation. The three models share the same unquestionable quality in manufacture and choice of fittings and appliances throughout which is why the judges deemed the H16 the winner of the Best Build Quality in this year's Australia's Best Hybrids competition.

The chassis is hand-welded in-house using 150mm x 50mm x 3mm Australian-made DuraGal steel from BlueScope, which is then coated with Hammertone for the ultimate stone protection and longevity.

Supporting the A-Frame is a quality ARK XO750 jockey wheel while Cub's take on independent trailing arm suspension soaks up bumps.

The body is timber-free with composite panels measuring 30mm for the walls and ceiling and a 40mm sheet used for the

floor. The panels are made in Australia and designed to handle our extreme temperature changes. The Polyfabric used in the top is from Wax Converters, again locally made and quality. Although the Polyfabric will not have the same insulative properties as the composite panels, I found the H16 comfortable on a hot day. To keep warm and heat water there is a modified Webasto diesel heater neatly tucked into a side locker.

The interior fitout is both gorgeous and practical with Rimex embossed stainless-steel benchtops a standout for their ease of cleaning and durability. A huge amount of light and air is allowed inside through oversized windows that feature blackout blinds for privacy.

INNOVATION

Along with the timber-free construction, the use of space stands out as an innovation in the H16. To have under-bed storage is a given in a trailer with a north-south bed layout but Cub has consciously designed the layout of

the dividers to suit particular, and common, IKEA storage containers. This gives owners the option to dedicate containers to certain things and to pack them in advance while still at home, knowing they'll fit exactly where they are meant to.

The same can be said about the front locker and adaption of the Webasto diesel hot water service and space heater. The design will allow users to stow all manner of camp chairs, fishing gear, poles and extra shades for their travels; the H16 is really very well considered throughout in terms of smart storage. Also clever is how the Webasto's glycol tank has been made in-house to fit the space in its side locker perfectly allowing for more storage options.

Although becoming more popular as manufacturers discover their ease of manufacture, the use of timber-free composite panels is still somewhat innovative. Their inherent insulative properties, light weight and ease of repair stand out.



2024
AUSTRALIA'S BEST
HYBRIDS
 PRESENTED BY
CARAVAN **WORLD** | **TOUGH DOG**
EQUAL OVERALL
WINNER

★★★
BEST BUILD QUALITY
BEST COUPLES HYBRID
 ★★★

BUILD QUALITY ★

"The three models share the same unquestionable quality in manufacture and choice of fittings and appliances throughout"

CLOCKWISE FROM RIGHT The Rimex stainless-steel external kitchen; Great external storage; Voted Best Couples Hybrid



ALLISON WATT

CARAVAN WORLD DEPUTY EDITOR

VALUE FOR MONEY

The H16 is a less spec'd up, more affordable pop-top version of the popular C16 – Cub's first foray into full-sized caravans which debuted in late 2022, winning awards for its engineering and design and, quite frankly, blowing people away with its simplicity, style and quality. The C16 was followed closely by the L16 – a lighter, more affordable full caravan.

The base model of the H16 is priced under \$100k and, at \$89,990, it's easy to see why more than 100 of these have sold since they were released in August last year.

The H16 boasts the same layout as C16 but without a few of its wow factors such as the felted fabric walls, huge windows (because of the pop-top canvas) and the vanity basin in the ensuite.

But even without those features, the H16 oozes clean, simple, timeless design, magazine-worthy decor, a comfortable layout, quality frameless composite construction and next-level engineering.

The base model is fine if you prefer caravan parks or limited off-grid camping. The options which were fitted to our review van – the Off-Grid Pack and the Techno Pack – bump the price up to \$110,615 but will take you anywhere in the Aussie outback in absolute comfort, which is what Cub designs and builds its vans to do.

SELF-SUFFICIENCY

The standard H16 comes with 100L of freshwater, a 100L grey water tank, a 150Ah lithium battery and two 180W REDARC solar panels, as well as two 4kg gas bottles for external cooking on the three-burner Dometic cooktop. Heating and hot water are provided by the Webasto EVO5. That's enough to enable a couple to stay off-grid for a few days, but the water will soon run out as 100L is not a lot.

The Off-Grid Pack (\$4900) extends the freshwater capacity by another 100L (you can upgrade another 100L taking the total to 300L), gives you an extra 150Ah lithium battery and two additional 180W solar panels coupled with a 40Ah charger.

For another \$6k or so, the Techno Pack offers the REDARC RedVision Total Vehicle Management System which allows you to monitor water and battery levels and control the lighting and fridge. The 3000W inverter and reverse camera are also included in the Techno Pack. The manual step, Webasto air-conditioner, Smart TV, NCE washing machine and Nature's Head composting toilet are all available as separate options.

Those two optional packs add an additional \$10,900 to the base price but there's nothing superfluous there – all those options are necessary if you are going to spend time off-grid, so the base price is

somewhat of a hook to reel you in.

In harsh Australian conditions, the benefits of a well-insulated van can't be underestimated and the thermal properties of the composite panels with 30mm of closed cell foam sandwiched in the middle will keep you cool in the heat and warmer in the cold.

TOWABILITY

The H16 was a dream to tow along the road to Tathra Beach and beyond from our judging location in Kangarutha Park, NSW. We couldn't fault it.

With a tare of 1976kg, the LandCruiser 200 Series pulled it effortlessly, aided by its narrow width (2.23m/7ft 3in), a travel height of just 2.515m (8ft 3in) without the optional roof-top air-conditioner, Cub's own independent suspension and 12in electric brakes. The extended drawbar also enhances its towing and reversing capabilities.

But don't worry if you don't own a LandCruiser. The H16 is light enough to be towed by an average 4WD dual cab ute or mid-size SUV such as an Isuzu MU-X.

Without the need to buy a big vehicle to pull the H16, invest whatever leftover cash you have into either or both of the optional upgrades – the Off Grid Pack and the Techno Pack.

■ **VALUE FOR MONEY** ★

“At \$89,990, it's easy to see why more than 100 of these have sold since they were released in August last year”



LEFT AND ABOVE Clever layout and simple but elegant decor; The beautiful Rimex stainless-steel internal kitchen



2024
AUSTRALIA'S BEST
HYBRIDS
 PRESENTED BY
CARAVAN **WORLD** | **TOUGH DOG**
EQUAL OVERALL
WINNER

★★★
BEST BUILD QUALITY
BEST COUPLES HYBRID
 ★★★

ABOVE The king size bed has a huge amount of storage underneath

CUSTOMER CARE ★

"It's easy to find the warranty details on the Cub website; a couple of mouse clicks and the warranty is spelled out"

MALCOLM STREET
 CARAVAN WORLD FIELD EDITOR

LIVEABILITY

The H16 also took home the Best Couples Hybrid category at ABH. The H16 has a slightly different layout from most of the hybrids we looked over, but being a little different doesn't mean it's impractical – quite the opposite. An additional bonus liveability factor was that despite producing a hybrid with many features on board, Cub has paid some attention to keeping the overall weight down.

Inside the H16, the king bed up front offers a very peaceful night's sleep. Easy access to the bed is assured by the sideways-facing lounges on either side of the hybrid and the split table with Lagun mounts on both sides is a simple and very effective idea. A design like the pop-top H16 does result in limited internal storage. However, the IKEA storage pods under the bed are a terrific idea. Not only for making effective use of the available space but also for making it very easy to get to. There is also the more traditional under-bed drawer as well.

Fitting neatly into the rear corner, the ensuite is a neat compromise of space and functionality. There's enough room for the shower and standard Thetford chemical toilet or the optional Nature's Head composting toilet. The latter item is a great idea in an off-grid van, it has more capacity than the usual toilet cassette tank.

Along the rear wall, the internal kitchen has a decent array of drawers and cupboards surrounding the kitchen bench with its stainless-steel sink and 110L compressor fridge. Outside, the external kitchen is well set up. There's a fridge slide to suit the optioned-on EvaKool fridge and a kitchen bench slide-out, the latter sitting sideways to the van body. It's well fitted out with a sink, three-burner hob, drawers and extending benchtop. Even though the H16 is a relatively small camper, it still has plenty of external storage both within the body and on the drawbar.

Cub's H16 is a very deceptive hybrid. Its design is very subtle, nothing overstated but one built from considerable experience into a very practical camping package.

CUSTOMER CARE

Like any RV warranty, which in Cub's case runs to four pages, it's worth the read. Apart from anything else, it lays out the responsibilities of both the manufacturer and the user. Frequently, during a purchase process, the warranty is not considered until near the end. However, it's worth doing a little pre-purchase research – it may well be helpful when decision-making time comes along. Not all warranties are created equal.

Cub has an extensive dealer network in all states, territories and New Zealand. In some cases, there's more than one state dealer.

Consequently, there's plenty of backup for service and repairs. The use of the Cub Tech Centre QR further assists customer support. Conveniently located in the electrics locker/external kitchen, it gives access to user manuals and resources.

The manufacturer offers one of the better warranties in the RV industry – five years on structural, manufacturing and lithium batteries. Of note is that it's easy to find the warranty details on the Cub website; a couple of mouse clicks and the warranty is spelled out.

Like many RV manufacturers, there are various parts to the Cub warranty. Structural items like the suspension, internal framework, electrical wiring, drawer slides and latches, toolbox, mattress and lithium batteries all have a five-year warranty. Fittings like the REDARC battery management system, gas cylinders and gas struts have at least a two-year warranty. Everything else, like the fridge, air-conditioner and TV, either has a minimum of 12 months or that of the original equipment manufacturer. Cub must approve any warranty claim repairs before any work commences.

As long as the H16 is used for its intended purpose, Cub Campers places no restrictions on where it's used. However, the H16 must be serviced as required and the warranty only applies to the original user.

CUB H16

WEIGHTS AND MEASURES

Overall length 7.15m (23ft 6in)
External body length 4.86m (15ft 9in)
Internal body length 4.8m (15ft 7in)
External body width 2.23m (7ft 3in)
Travel height 2.515m (8ft 3in)
Internal height 2.035m (6ft 7in)
Tare 1976kg (1844kg standard)
ATM 2500kg
Payload 524kg (calculated) (656kg standard)
Ball weight 181kg (150kg standard)
Ball weight at tare 9.2% (calculated)

EXTERNAL

Frame Frameless design
Cladding Composite panel – fibreglass extrusion with closed cell foam (30mm walls and roof, 40mm floor)
Chassis BlueScope steel 150mm x 50mm x 3mm
Suspension Cub independent suspension
Coupling AL-KO 50mm offroad – 3500kg rating
Brakes 12in electric
Wheels 17x8 black alloy (6/139.7 PCD), tyres 265/65R17 Dunlop Grandtrek AT3G
Water 2 x 100L freshwater (1 x 100L standard), 1 x 100L grey water tank
Battery 2 x 150Ah lithium (1 x 150Ah standard)
Solar 4 x 180W REDARC solar panels (2 x 180W standard)
Air-conditioner Webasto rooftop reverse cycle (optional)
Gas 2 x 4kg for external cooking only
Sway control Optional
Cooking Dometic three-burner cooktop
Fridge Evakool (optional)

INTERNAL

Cooking N/A
Microwave N/A
Fridge 110L Dometic Coolmatic CRX upright compressor fridge/freezer
Bathroom Internal ensuite shower and toilet, plus external shower
Hot water Webasto diesel heating and hot water system

PRICE FROM \$89,990

OPTIONS FITTED

- Manually operated step
- Webasto air-conditioner
- 27in smart TV
- TV swivel bracket
- Nature's Head compost toilet
- NCE washing machine

Off Grid Pack:

- 1 x 100L freshwater tank
- 1 x 150Ah battery
- 2 x 180W solar panels

Techno Pack:

- REDARC RedVision Total Vehicle Management System
- 3000W inverter
- Reverse camera

PRICE AS SHOWN \$110,615

MORE INFORMATION

Cub Campers
 23 Loyalty Road
 North Rocks NSW 2151
 P: 02 8838 8600
 E: sales@cubcampers.com.au
 W: cubcampers.com.au

JOHN FORD

CARAVAN WORLD EDITOR-AT-LARGE

EASE OF USE

The H16 from Cub shows all the experience of a builder making durable and user-friendly campers since 1968. The van is all about making everything quick and easy – from the electric lifting roof to the Cub Tech Centre QR codes for instructions on everything you want to know. Cub claims a setup time of 40 seconds, which is close to our experience.

The outside kitchen deploys quickly on easy glide rollers and looks solid and durable with excellent ergonomics in a straight line of benches. Having a fire extinguisher right next to the hotplates is a clever move. Inside, the face-to-face seating and the split table make a space that's effortlessly versatile, spacious and comfortable. The plush full-width bed guarantees a good night's sleep and allows smooth access for both partners.

I found the ensuite large enough and well laid out, and the extra outside shower is an excellent idea for a quick wash down after a swim or a tub with a view of the wilderness. Hitching and setting up camp are assisted by a heavy-duty ARK 750 jockey wheel and an AL-KO drop-on hitch, which are reliable and easy to use.

The multiple storage options make it simple to find what you need, and the front storage box and addition of externally sourced soft boxes under the bed will help sort various items.

The optional Off Grid Pack adds water and the REDARC RedVision system which has ample capacity to run appliances seamlessly from the 3000W inverter. Let's remember Cub's online buying portal, where you can choose your options and talk to an adviser without leaving home. How easy is that?

X-FACTOR

The essence of the H16 is understated refinement. The simple, well-balanced exterior announces a van that needs no gaudy graphics to prove its worth. Instead, there are layers of inspired design that work properly. Years of designing and testing offroad campers have

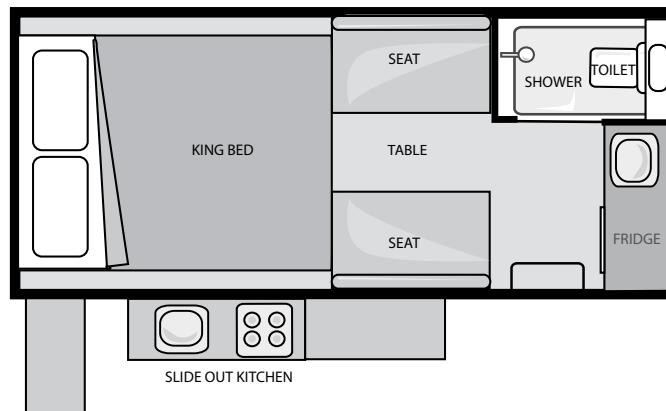

BEST BUILD QUALITY
 BEST COUPLES HYBRID



gone into Cub's first range of caravans, with the full-height C16 version winning a Good Design Award on debut. This hybrid version doesn't disappoint and is the Equal Overall Winner of Australia's Best Hybrids 2024, not to mention also taking home the Best Build Quality and Best Couples Hybrid categories. It carries simplicity and elegance into the outdoor kitchen style with beautifully crafted stainless steel and elegant internal joinery.

The Cub is a true dingo in sheep's clothing. Its elegant minimalist vibe disguises a capable offroader that will get into places where a larger, heavier van will struggle. It has the self-sufficiency for extended travel and the comfort to enjoy the ride, and I could see many couples happily choosing this little hybrid for a big lap.

Buyers looking for a practical and capable solution and those who love it for the aesthetics and sound design will both find it tempting. 

X-FACTOR ★

"The simple, well-balanced exterior announces a van that needs no gaudy graphics to prove its worth"